

REVISION RECORD				
REV	ECO	DESCRIPTION	DRFT	CHKD

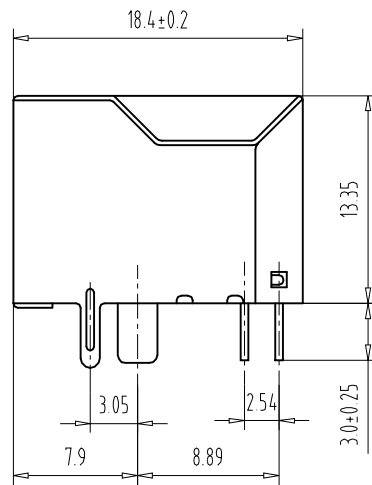
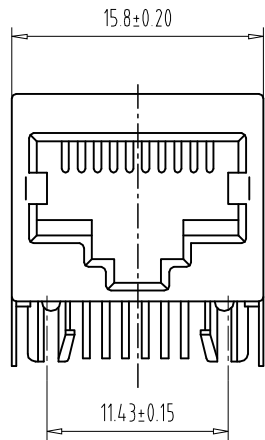

NOTES:

MATERIAL :

- | | |
|--------------------|---|
| 1.HOUSING MATERIAL | :GLASS FILLED POLYESTER UL94V-0. |
| 2.CONTACT MATERIAL | :PHOSPHOR BRONZE ϕ 0.45mm. |
| 3.PLATING | :GOLD PLATING OVER NICKEL. |
| 4.SHIELD | :0.20mm THICKNESS COPER ALLOY WITH NICKEL PLATED. |

ELECTRICAL:

- | | |
|--------------------------------------|------------------------------|
| 1.VOLTAGE RATING | :125 VAC RMS. |
| 2.CURRENT RATING | :1.5 AMP. |
| 3.CONTACT RESISTANCE | :30 MILLIOHMS MAX. |
| 4.INSULATION RESISTANCE | :500 MEGOHMS MIN @ 500V DC . |
| 5.DIELECTRIC WITHSTANDING RESISTANCE | :1000V AC RMS 50Hz. 1MIN. |

MECHANICAL:

- | | |
|----------------------------|------------------|
| 1.DURRABILITY | :750 CYCLES MIN. |
| 2.PCB RETENTION PRE-SOLDER | :1 LB MIN. |

ENVIRONMENTAL:

- | | |
|--------------|----------------|
| 1. STORAGE | : -40°C~+85°C |
| 2. OPERATION | : 0°C TO 70°C. |

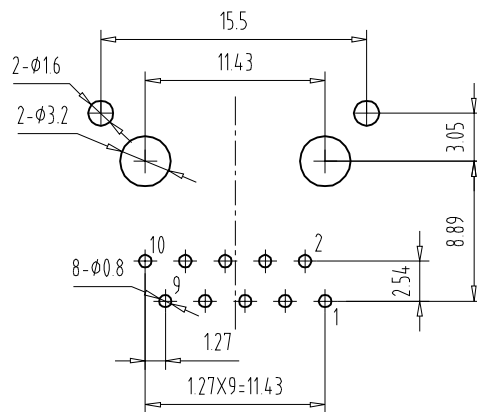
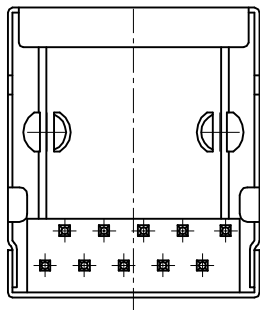

PC Board Layout
Component Side Shown

DETACHED LISTS MM INCH TOLERANCES EXCEPT AS NOTED MM .1 ± 0.15 .25 ± 0.075 .38 ± 0.15 ANGLES ± 0.5 THIRD ANGLE PROJECTION	DFTO: SHB CHKD: LANBO MFO: APPVL: MATERIAL : Q.T'Y : FINISH : SCALE :	DATE: 2007.05.03 DATE: 2007.05.03 DATE: DATE: DATE: DATE: DATE: DATE:	<h1 style="text-align: center;">Coorle Technology</h1>	
	TITLE <h2 style="text-align: center;">56 1X1 SIDE ENTRY JACK 10P10C W/ SHIELD</h2>			
	DRAWING NO. TES661002 /PART NO.		SIZE A3	REV 0
	DO NOT SCALE DRAWING		SHEET X OF Y	